

01 MAY 2019

# THE DESIGN EDGE

CREATING QUALITY SPACES



Major highlights of the month:

COLLEGE DEKHO  
11<sup>th</sup> FLOOR DIGITAL GREENS



## ONGOING PROJECTS

1. CHARGE POINT TECHNOLOGIES INDIA PVT LTD.

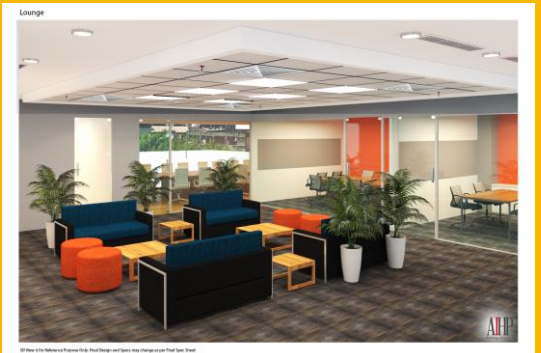

2. BVC ESERVICES PVT LTD.



3. CLARION INDIA PVT LTD.



4. SIX DEE NETAD SOLUTIONS PVT LTD.



## RECENT BEST PROJECTS

1

SDREEN INDIA PVT. LTD.



2

AEO DESIGN CONSULTANTS PVT.  
LTD.



# ABOUT AIHP

**AIHP** is a one stop shop for the conceptualization, creation, implementation and management of world-class workplace environments. Our concept is unique; we are the first to offer corporate office space as a product rather than a group of outsourced services.

For our customers the age old business challenge of expanding, relocating or starting an office is reduced to answering a few short questions on basic business requirements. Sixty days later our customers plug in their laptops and start working, without the worry of ever having to change a light bulb!

Our backward integrated model is the foundation of our product. We are the largest corporate landlords in Gurugram, with over a million square feet of commercial real estate. Our in house specialized teams provide the end-to-end product delivery which includes conceptualization, design, architecture, manufacturing of furniture, office fit-outs, incubation, workplace management and hospitality.

## VISION

To be India's first corporate landlord, backward integrated company and preferred corporate brand for end to end conceptualization, creation, and management of world class workplace environment.

## MISSION

To contribute to the needs of corporate customers for work space.  
To be reliable and transparent in all our relationships with clients, employees and business partners.

## VALUES

Customer delight through ethical and professional service.  
Operational efficiency and excellence through creativity.  
Unyielding integrity in everything we do.

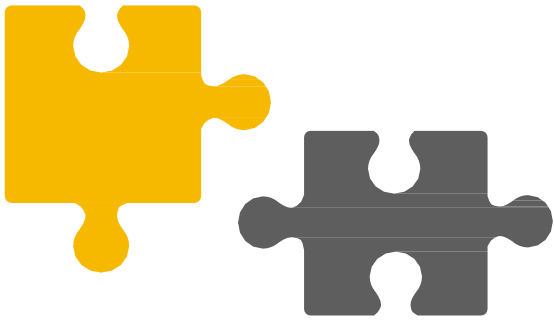

# CONTENTS

1. EDITOR’S NOTE	1
2. BEST RECENT PROJECT	2
3. CONCEPT & PRINCIPAL OF INNOVATION	3-4
4. BIRTHDAY CELEBS & EVENTS	5-8
5. HAPPY BEGINNINGS	9
6. EDITORIAL TEAM	10



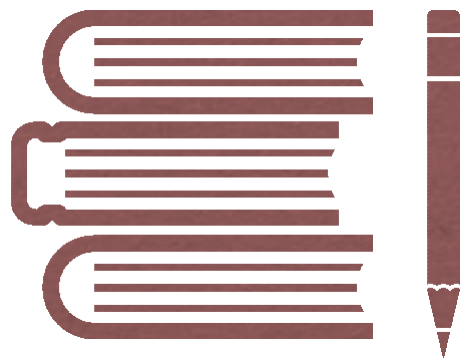

## EDITOR'S NOTE

### Flowers – source of joyful life



Flowers are regarded as a symbol of love, beauty and a gift of nature. Flowers are used by us to provoke the feelings of love and happiness because they have the power to make people happy and cheerful. On different occasions people make use of different kinds of flowers. Different kinds of flowers express different meanings. For example, the magnificence and tenderness of red rose has been widely praised ever since the ancient times. A red rose bouquet helps to convey the feelings of love towards the person whom you love without saying any single word. Coloured roses like white (purity), red (love), lavender (excitement), yellow (joy), orange (enthusiasm), dark pink (gratitude) and light pink (admiration) also express different emotions of our life.

Apart from expressing feelings and emotions, studies have also shown that flowers are capable of influencing our moods. Beautiful flowers kept in hospital rooms can reduce the stress of patients and improve their recovery. It has also been seen a vase filled with fresh flowers in the drawing room, dining room and living room creates a relaxing atmosphere and enhances the beauty of home. A lot of studies even proved that flowers have healing properties as well. Presence of multi-coloured flowers can produce joyful impact on people's mind. A garden and a park full of different flowers is the best place to spend some quality time. If you have worries or are depressed, you will see how these flowers can impact our lives. You will feel a lot more relaxed and refreshing after sitting in the park or garden with full of flowers.

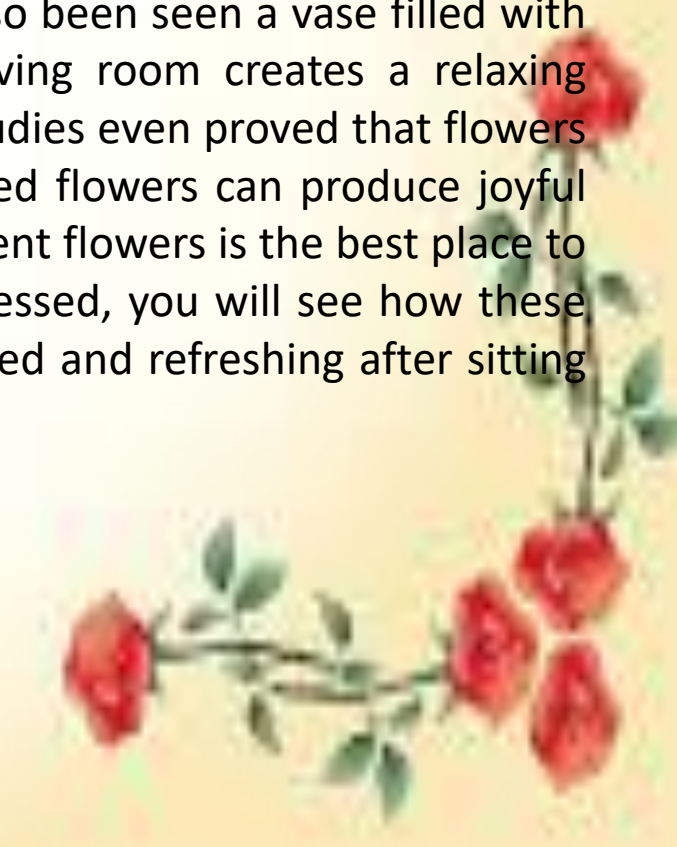





# SMART PARTS ONLINE PVT. LTD.

12<sup>TH</sup> FLOOR, DIGITAL GREEN, GOLF COURSE ROAD

RECEPTION



CONFERENCE



CABIN



WORKSTATION VIEW

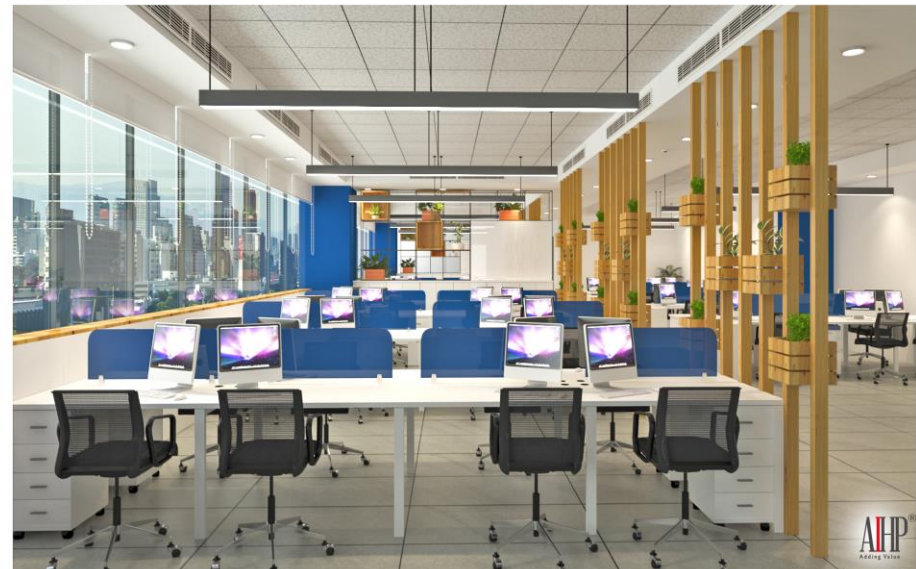

3D View is for Reference Purpose Only. Final Design and Specs may change as per Final Spec Sheet

3D View is for Reference Purpose Only. Final Design and Specs may change as per Final Spec Sheet

CAFETERIA



3D View is for Reference Purpose Only. Final Design and Specs may change as per Final Spec Sheet

Industrial interior design, and today's post celebrates this growing trend. Industrial design showcases neutral tones, wood and metal surfaces. The entire office is having a industrial look and a pop of color in the recreational zone and the pantry which makes it a fun area .

# CONCEPT AND PRINCIPLES OF INNOVATION

Steve Jobs stated once that the “design is not just what it looks like and feels like. **Design is how it works.**” While this statement has proven to be crucial over thousands of years, one shouldn’t misinterpret it by emphasizing the functionality *despite* the design. When it comes to product design, the significance of aesthetics of a given device, the way its design *looks and feels*, determines the choice of the customer once the functionalities of multiple devices are more or less similar. If supported by sound user interface and a well-tested, clean implementation, innovative design solutions can drastically enhance the user experience.

Innovation is a new approach that represents an improvement by an order of magnitude over the old way of doing things. Design is a process of synthesis that solves problems by creating something new. As such, an innovative design is the synthesis of new value that has the potential to transform a community, industry, society, economy or environment.

Innovation principles are guidelines that an organization adopts as a basis for innovation activities. They are typically considered foundational statements that are intended to guide innovation decisions, culture, programs and projects. The following are general innovation principles that have achieved widespread adoption.

**Design for scale** : Designing things to be useful to a great number of people. Design for scale also implies that innovations benefit from economies of scale, meaning that unit cost drops as you produce more.

**Customer focus** : Valuable innovations fulfil customer needs and wants.

**Fail often** : is a method of innovation that tests a large number of fearless ideas with the reasonable expectation that most will fail and a few will succeed. According to the fail often method, a lack of failure is a sign that you're not pushing hard enough to innovative.



**Precautionary principle** :The principle that an innovation be generally accepted as safe and sustainable before being launched to the public or released into the environment.

**Order of magnitude** : The goal of innovation is to take leaps forward by creating things that are an order of magnitude better than the current state of the art.

**Feedback loop** : An iterative process of using feedback from sources such as customers to quickly improve an innovation.

**Innovation culture** : An organization's values, norms, habits, history, symbols and work environment impact its ability to innovate. Based on the observation that some corporate cultures are able to generate a steady stream of valuable innovations while others struggle.

**Measure and improve** : The principle that each innovation be measurable. A means of measurement is often a basic criteria for accepting innovations for evaluation.

**Open innovation** : Innovation is shared in the open in order to harden designs with peer review and feedback.

**Reuse and improve** : Innovation reuses existing knowledge, technology and resources where possible. Discourages the common perception that innovation is always greenfield. In many cases, valuable innovations are a slight variation of an existing product, service or process.

Dr. S.K.Gupta  
(Director – Corporate Affairs)





## BIRTHDAYS IN MAY

# HAPPY BIRTHDAY

S.NO	BIRTHDAYS IN MAY	DATE
1.	VINEET KUMAR (PURCHASE EXECUTIVE)	1 <sup>ST</sup> MAY
2.	LALAN KUMAR JHA (MAINTENANCE EXECUTIVE)	1 <sup>ST</sup> MAY
3.	AMIT NARULA (DGM – FINANCE & ACCOUNTS)	3 <sup>RD</sup> MAY
4.	VINOD KUMAR (SITE SUPERVISOR)	5 <sup>TH</sup> MAY
5.	MADHURI WADHWA (SR. MANAGER – LEGAL)	5 <sup>TH</sup> MAY
6.	SANJEEV KUMAR (EXECUTIVE – ARCHITECTURE & INTERIOR DESIGN DEPARTMENT)	8 <sup>TH</sup> MAY
7.	VISHAKHA SRIVASTAVA (COMPANY SECRETARY)	9 <sup>TH</sup> MAY
8.	BAPPA MALIK (CARPENTER)	12 <sup>TH</sup> MAY
9.	ARUN KHANDELWAL (CHIEF BUSINESS OFFICER- IFS )	12 <sup>TH</sup> MAY
10.	MUNNA RAJ (SR.EXECUTIVE - ARCHITECTURE & INTERIOR DESIGN DEPARTMENT)	14 <sup>TH</sup> MAY
11.	RACHANA M. SHANKAR (MANAGER - ARCHITECTURE & INTERIOR DESIGN DEPARTMENT)	19 <sup>TH</sup> May





BIRTHDAY CELEBRATION









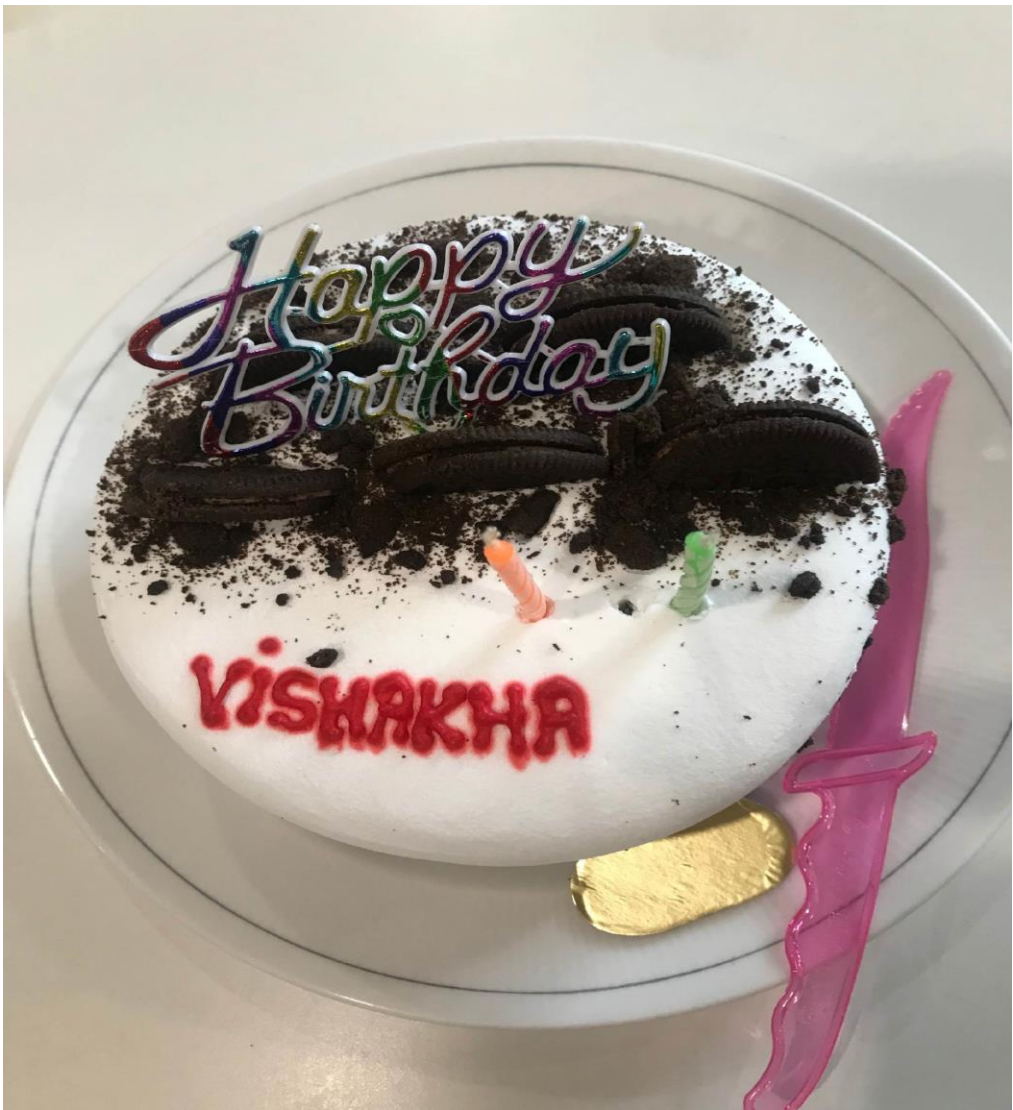





# HAPPY BEGINNINGS

AEO DESIGN CONSULTANTS PVT. LTD.



RIBBON CUTTING CERMONY



CAKE CUTTING CERMONY

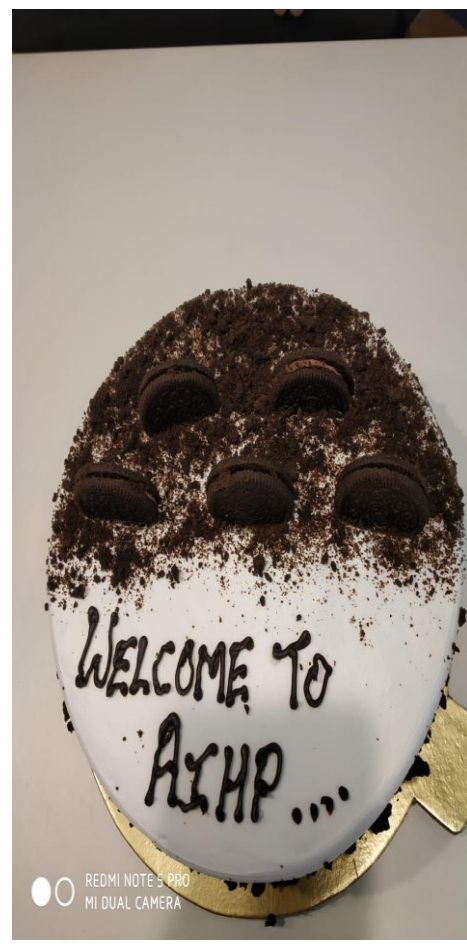

KEY HANDOVER CERMONY

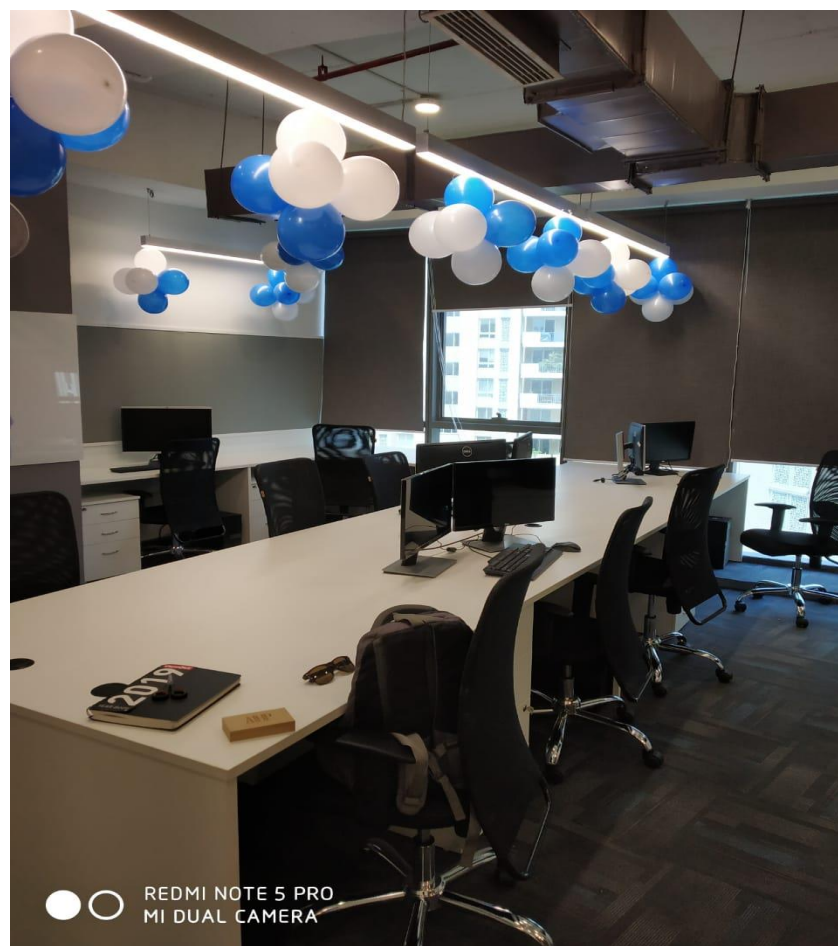



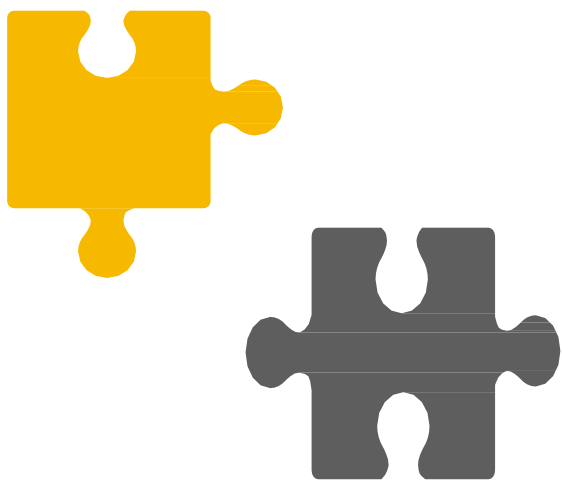

## EDITORIAL TEAM

Dr. S.K. GUPTA  
YOGESHWAR KANU  
SHUBHAM JAIN

AIHP Tower, 249 G, 3rd Floor, Udyog Vihar, Phase-IV, Gurugram-122015, Haryana  
Contact: +91-124-4837800

<http://www.aihp.in/>