

01 SEPTEMBER 2018

THE DESIGN EDGE

CREATING QUALITY SPACES



Major highlights of the month:

FINZOOM INVESTMENT ADVISORS PRIVATE LIMITED.

SUCCESS TOWER – 204



ONGOING PROJECTS

1. THE HEALTH NEST



2. VISION RT LTD.

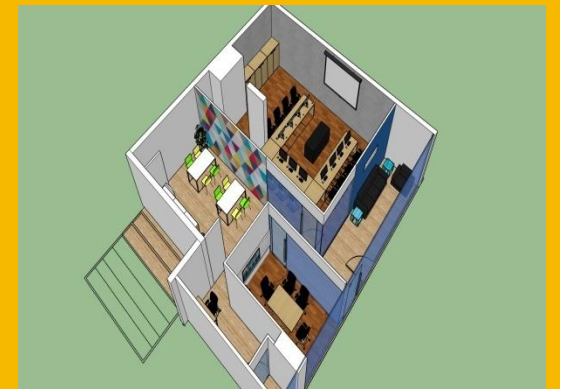

3. SEGROW BIO-TECHNICS INDIA PRIVATE LIMITED.



4. YOMATO INDIA



RECENT BEST PROJECTS

1

MIKI TRAVEL (HONG KONG) LTD.

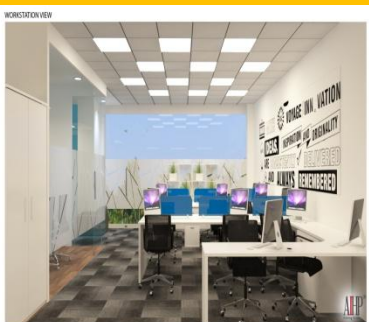

2

ZENATIX SOLUTIONS PRIVATE LIMITED .



3

EMPIRIX, INC



ABOUT AIHP

AIHP is a one stop shop for the conceptualization, creation, implementation and management of world-class workplace environments. Our concept is unique; we are the first to offer corporate office space as a product rather than a group of outsourced services.

For our customers the age old business challenge of expanding, relocating or starting an office is reduced to answering a few short questions on basic business requirements. Sixty days later our customers plug in their laptops and start working, without the worry of ever having to change a light bulb!

Our backward integrated model is the foundation of our product. We are the largest corporate landlords in Gurugram , with over a million square feet of commercial real estate. Our in house specialized teams provide the end-to-end product delivery which includes conceptualization, design, architecture, manufacturing of furniture, office fit-outs, incubation, workplace management and hospitality.

V I S I O N

To be India's first corporate landlord, backward integrated company and preferred corporate brand for end to end conceptualization, creation, and management of world class workplace environment.

M I S S I O N

To contribute to the needs of corporate customers for work space.
To be reliable and transparent in all our relationships with clients, employees and business partners.

V A L U E S

Customer delight through ethical and professional service.
Operational efficiency and excellence through creativity.
Unyielding integrity in everything we do.

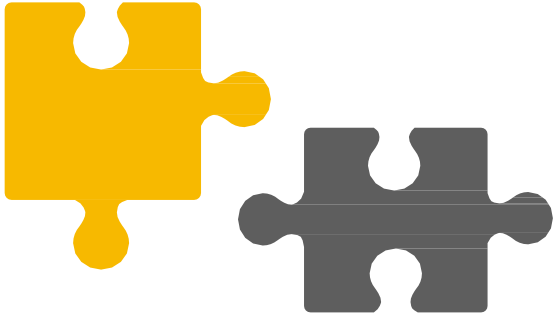

CONTENTS

1. EDITOR'S NOTE	1
2. BEST RECENT PROJECT :FINZOOM INVESTMENTS ADVISORS (P) LTD..	2
3 VASTU SASTRA TIPS FOR OFFICE	3-4
4. BIRTHDAY CELEBS	5-7
5. HAPPY BEGINNINGS	8
6. EDITORIAL TEAM	9



EDITOR'S NOTE

FINDING JOY IN WORK

We spend a significant amount of our life working. It is a large piece of our life. And it is important to think thoughtfully and intentionally about it. There are countless people who are happy with their work. They find meaning, significance, and joy in it. Additionally, there are many people who are unhappy with their work and choose to spend part of their life complaining about it.

Interestingly enough, these differences in attitudes have little to do with the actual work being done—in fact, two people in the same field can have completely different responses to the same job. This is because it means enjoying work has less to do with your actual job and more to do with your attitude towards it. Changing our attitude towards work is often far easier than changing jobs. It also means that, you can be happy in your work today. You can find joy and fulfillment in it. And sometimes, this can come with a simple change in thinking.

Whether by creation or evolution, humans are designed to work. This is an important part of our nature. The realization that we are designed to work is an important first step in finding fulfillment in it—even though “work” looks different for each of us. If we are designed to accomplish work, it is not something to be avoided. Instead, it is something to be sought, welcomed, and enjoyed.

Most people don't love their work. Many like it, some tolerate it, but it is a minority who find work they love that also supports their lifestyle. Does that mean that everyone else is left to live in frustration, desperately seeking that perfect job they can be passionate about? Not at all.

So, paraphrasing a verse Stephen Stills penned,
 If you can't be in the job you love...
 Love the job you're in (or the way you do it)
 It will make YOUR JOB much more enjoyable and rewarding.



FINZOOM INVESTMENT ADVISORS PRIVATE LIMITED.

GOLF COURSE EXT ROAD , SECTOR 65



The design has been focused on creating a vibrant, energetic and positive space to enhance productivity .

Yellow dominates the space brightening up the environment complimenting the ample natural light in the office. The floor and ceiling has also received a quirky treatment with colorful patterns on the carpets and unique hanging elements adorning the ceiling. To reinforce the positive vibe a number of planters are dispersed throughout the office space to provide a touch of green to the environment.

The cafeteria and lounge has been given a hip vibe considering the average age demographics of the employees.

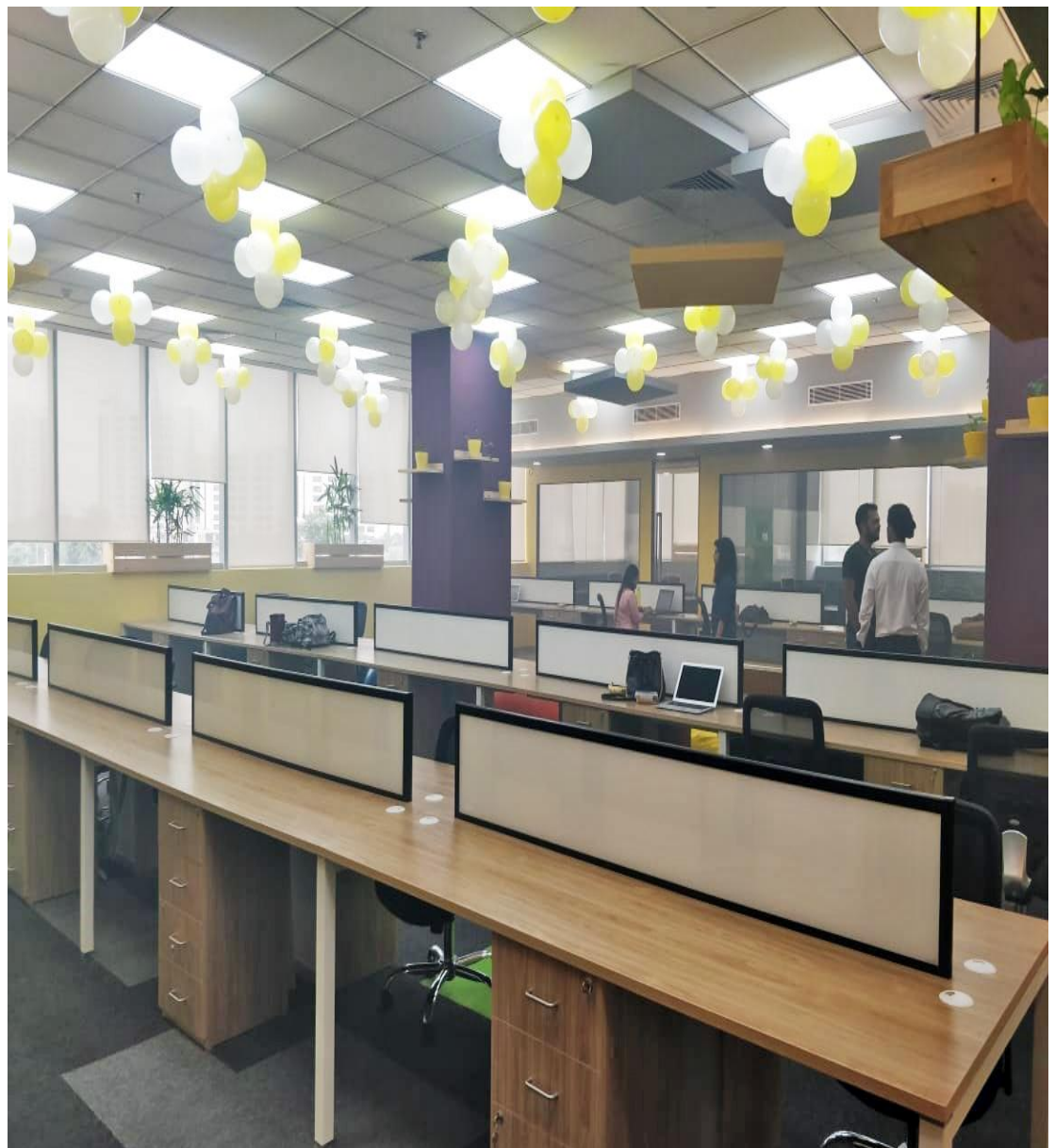

VASTU SHASTRA TIPS FOR OFFICE

Vastu Shastra, the ancient Hindu system of architecture, has been used in India for centuries. It prescribes guidelines for design, layout, ground preparation and other aspects that go into creating a harmonious dwelling. While the system doesn't have rigid rules for construction or design, it outlines the best possible layouts and solutions for bringing maximum success and prosperity to the business.

Vastu of office requires proper analysis and orientation. Here are some tips for Vastu compliant office:

- East facing office is considered good and bountiful.
- The reception is the place where visitors are greeted. This should be a positive and relaxing space that puts them at ease. Ideally, the reception area should be in the east or northeast direction and should have comfortable seating.
- The central part of the building should be left open for maximizing prosperity. An indoor garden or lounge in this area not only enhances profitability, but also provides an area for employees to recharge.
- The staff who handle the money and finances of the office should be placed in the southeast, and they should sit facing the north or east.
- The northwest direction is the best for gatherings. The conference room of the office can be planned in this area to facilitate fruitful meetings and discussions.
- Vastu also prescribes the use of square or rectangular desks or workstations. Avoid irregular shaped desks or even L-shaped furniture to maximize the positive energy in the area.

- All offices are highly reliant on electrical equipment. The best direction to place heavy electrical equipment to minimize breakdowns and repairs is in the southeast part of the building.
- Avoid irregular shape of the plot while square or rectangle is best for office structure.
- Water resource or element if any, must be placed or installed in North-east of the office.
- The main head or owner of the business organization must face North while working or dealing with clientele.
- Northern or eastern sides are suitable for executive and other staff.
- Managerial level and other high level people in the office must be made to sit in Southern or Western portion so that they must face North or East while sitting in office.
- North-east portion of office should be left empty with water resource installed.
- Toilets should be built in West or North-western side while avoid toilet in South-east, North-east & East.
- Pantry should be constructed in South-east.
- Staircase is best made in South, South-west or West. Avoid stairs in centre or Brahmsthan of office.
- Reception must be designed in North-east.
- If there is temple in the office construct in North-east .
- Do not make employees sit under the beam.
- Waiting room can be made in North-west or North-east.
- Colors in office should be pleasing and bright which do not spread sadness or gloom

DR. S. K. GUPTA
(DIRECTOR- CORPOARTE AFFARIS)



BIRTHDAY CELEBS

BIRTHDAYS CELEBRATION

S. NO	BIRTHDAYS IN SEPTEMBER	DATE
1.	RAHUL UPADHAY (EXECUTIVE - CUSTOMER SUPPORT)	18 TH SEP

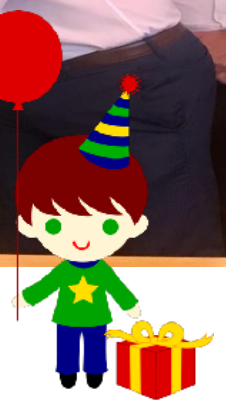

BIRTHDAYS CELEBRATION



INDEPENDENCE DAY CELEBRATION





HAPPY BEGINNINGS

FINZOOM INVESTMENTS ADVISORS PRIVATE LIMITED
GOLF COURSE EXT. ROAD, SEC 65



RIBBON CUTTING CEREMONY



CAKE CUTTING CEREMONY



KEY HANDOVER CEREMONY





HUMOUR SECTION

BOSS to an employee:

Do you believe in life after Death?

EMPLOYEE:

Certainly not, there's no proof of it

BOSS: Well, there is now

After you left early yesterday to go to your uncle's funeral, he came here looking for you



I KNEW EXACTLY WHAT TO DO.

BUT IN A MUCH MORE REAL SENSE

I HAD NO IDEA WHAT TO DO.

JOKEAZ.com

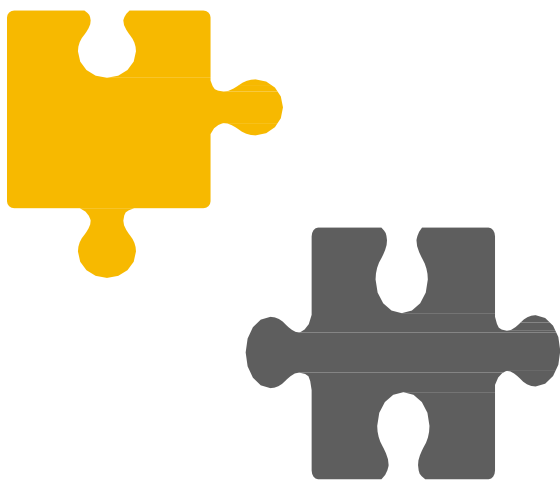

EDITORIAL TEAM

Dr. S. K. GUPTA
YOGESHWAR KANU
SHUBHAM JAIN

AIHP Tower, 249 G, 3rd Floor, Udyog Vihar, Phase-IV, Gurugram-122015,
Haryana Contact: +91-124-4837800

<http://www.aihp.in/>